

Courses & distances  
up Juniata River

- N 42 W 77
- N 55 W 20
- N 73 W 21.2
- S 77 W 29.3
- S 57 W 27
- S 40 W 26
- S 29 W 64

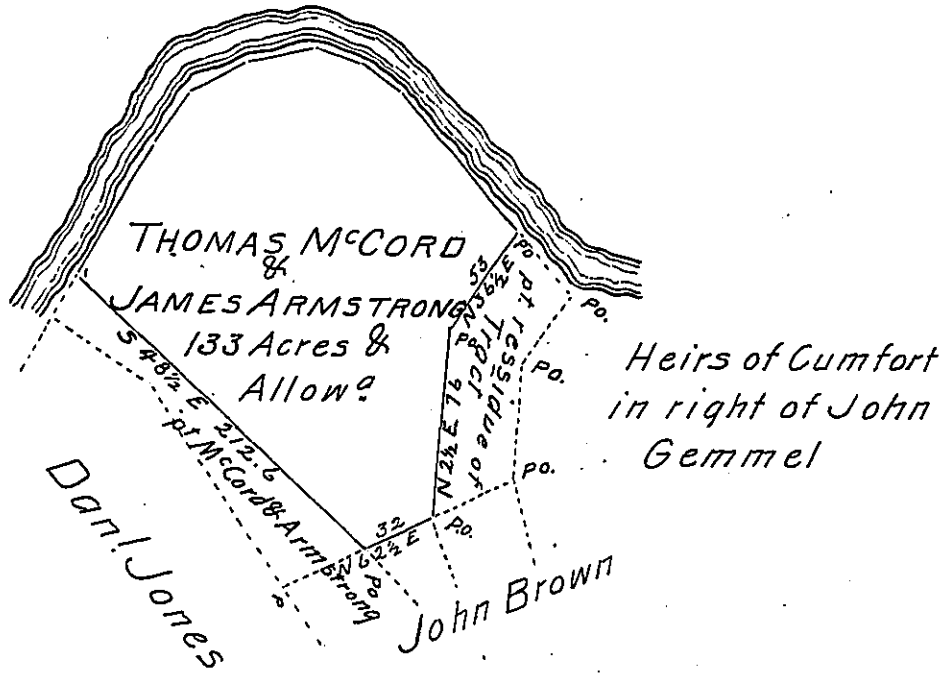

Draft of A Tract of land situated on the south side  
of Juniata River in Granville Township Millham  
County containing 133 Acres & Allowance of six Po.  
for roads &c being part of a larger Tract of  
182.2 Acres which appears to have been surveyed by  
Jas. Harris on 28<sup>th</sup> April 1767 in pursuance of  
a Warrant granted Thomas McCord & James Arm-  
strong dated 10<sup>th</sup> April 1755 and determination of the  
Board of Property of 30<sup>th</sup> June 1766. And divided by  
Robert Robison on — day of — and examined by me  
this 13<sup>th</sup> Jan'y 1840.  
To Jacob Gallade Esq } John Shaw D.S.  
Surveyor Genl. of Penna }

IN TESTIMONY that the above is a copy of the original remaining on file in  
the Department of Internal Affairs of Pennsylvania, made  
conformably to an Act of Assembly approved the 16th day of  
February, 1833, I have hereunto set my Hand and caused  
the Seal of said Department to be affixed at Harrisburg,  
this seventh day of March 1904.

*Samuel D. Benson*  
Secretary of Internal Affairs.